

尺寸:205\*140mm 20页



## Yale Kyra Pro

**ASSA ABLOY**

					Material 材料	印刷纸	亚萨合莱(广州)智能科技有限公司		
					Finish 表面处理		Product Name 产品名称	Kyra pro	
V1.0	2023.03.27		首次发布	Terry	Weight 重量 (g)		Part Name 零件名称	Kyra pro 英文 安装指导	
Ver. 版本	Date 日期	ECN 文件	Description 更改内容	Sign 签名	Scale 比例	1:1	Part No. 零件编号	49S00241	
Design/设计		Terry	2023.03.27				Unit 1 页	共 1 页	
Check/审核		Richard	2023.03.27				第 1 页		
Appd./批准		Allen	2023.03.27		3st angle Proj. 第三视角投影法		Unit/单位	mm	



## Table of contents

### 1 Preparation before installation

1.1	Product parts list	01
1.2	Optional accessories	03
1.3	Door direction confirmation	04
1.4	Mortise installation preparation	05
1.5	Installation of threaded pull tube, positioning plug and transmission plate	06
1.6	Main body handle cover removal	07
1.7	Door holes opening	07

### 2 Product installation

2.1	Mortise installation	08
2.2	Front body installation	09
2.3	Main body plate installation	10
2.4	Main body installation	11
2.5	Striker plate and striker box installation	12
2.6	Battery installation on main body	13
2.7	Acceptance test	14

\* The pictures in this installation manual are for illustration purpose only;  
actual product or parts may vary. \*



## Preparation before installation

### 1.1 Product parts list

#### Product main parts



Front body  
1x

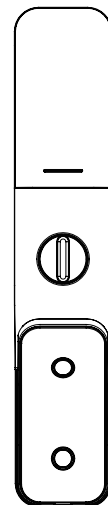

Main body  
1x



Main body plate  
1x

#### Mortise, striker plate, Striker box, screws

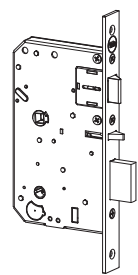

Mortise  
1x



Wooden door  
striker plate  
1x

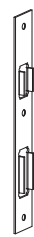

Steel door  
striker plate  
1x



Striker box  
1x



Mortise screw  
10x

\* Select the appropriate striket plate according to the application

## Installation Accessories Kit

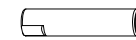

1. Threaded pull tube  
30mm/50mm/70mm  
3x each



2. Pull screw  
35mm/50mm/70mm  
3x each

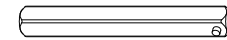

3. Spindle  
35mm/45mm/60mm/80mm  
1x each



4. Positioning plug 100mm  
2x

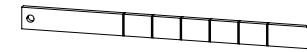

5. Transmission plate 100mm  
1x



6. Round head screw M4x8  
4x



7. Cotter pin 1x  
(for fixing of transmission plate)



8. Spindle Retaining Ring 1x  
(For securing spindle position)

## Accessories

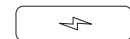

Alkaline AA battery 6x

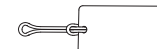

Card 4x



Mechanical key override 2x

### Note

- Please do not use or test the mechanical key override before the completion of installation to avoid potential complications and damages.



1.2 Optional accessories

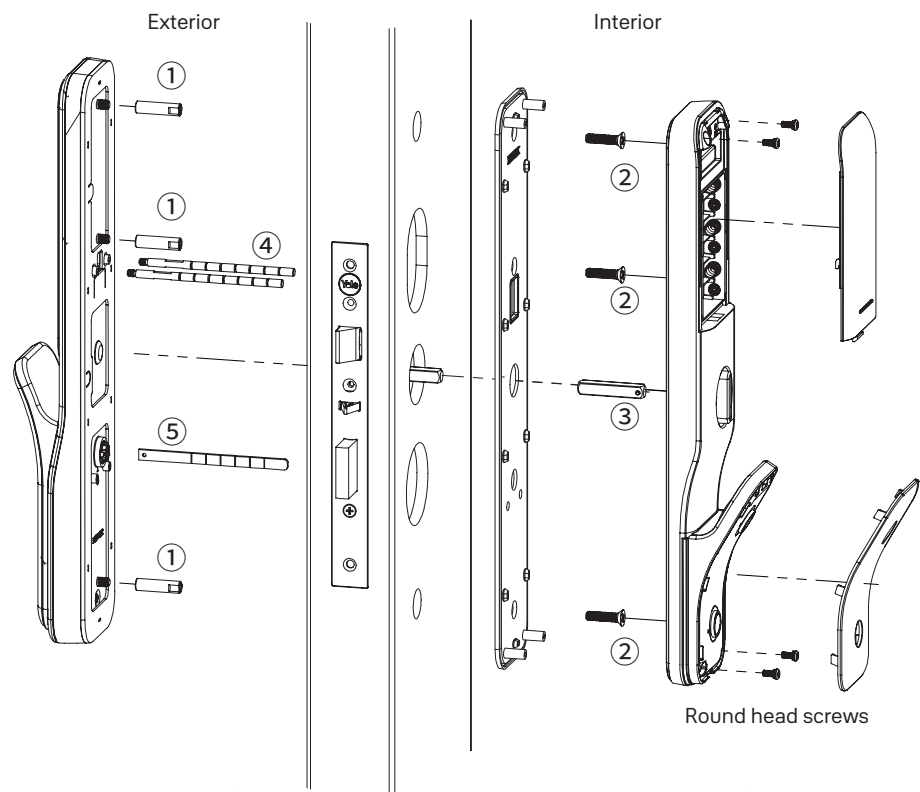

Table 1.2.1 Selection and customization of installation accessories

Door thickness (mm)	1 Threaded pull tube	2 Pull screw	3 Spindle	4 Positioning plug	5 Transmission plate
35-50	30	35	Please refer to Table 1.2.2	cut 7 sections 	cut 5 sections 
51-70	50	35		cut 6 sections 	
71-90	70	50		cut 4 sections 	cut 2 sections 
91-110	70	70		cut 2 sections 	

Remarks:

- ① Door thickness is the actual total thickness of the door.
- ② The default factory accessories package is only suitable for 35-110mm door thickness; other door thicknesses require customized accessories package

Table 1.2.2 Selection of spindle

Door thickness (mm)	3 Spindle	Remark
35-44	Length=35mm	L1≥17mm
45-59	Length=45mm	
60-79	Length=60mm	L1≥23mm
80-110	Length=80mm	

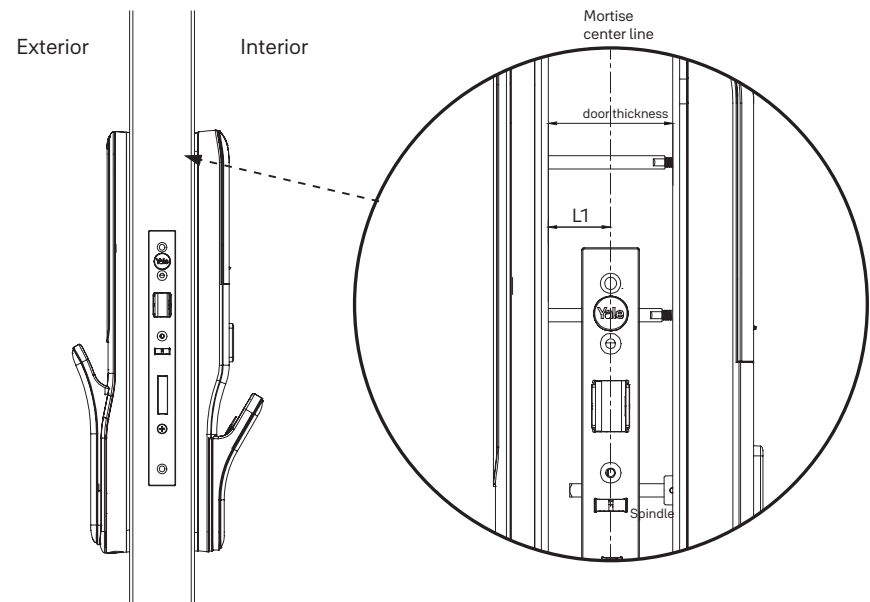

Note

- The distance from the mortise center line to the outdoor door edge is L1



1.3 Door direction confirmation

This product can be applied to doors with four opening directions: left inward-opening, left outward-opening, right inward-opening, right outward-opening. Take the person standing outside facing the door as the standard: if the hinge of the door is installed on the left side, then the door is a left opening door, and if the hinge on the door is installed on the right side, then the door is a right opening door.

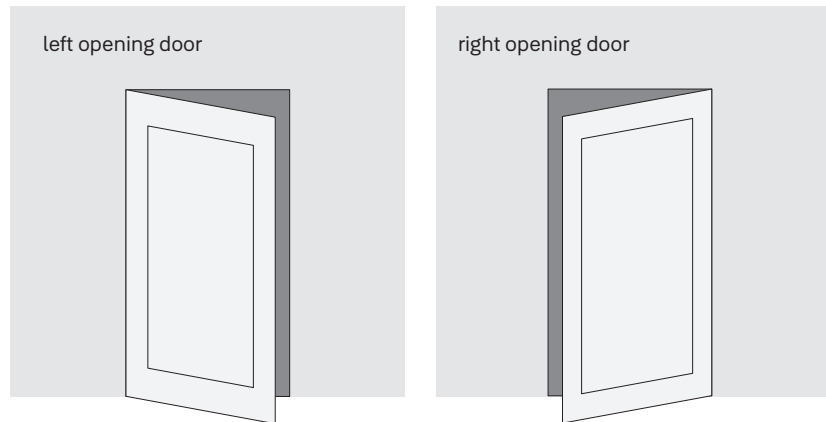

Outward door - Door is pulled outwards.  
Inward door - Door is pushed inward.

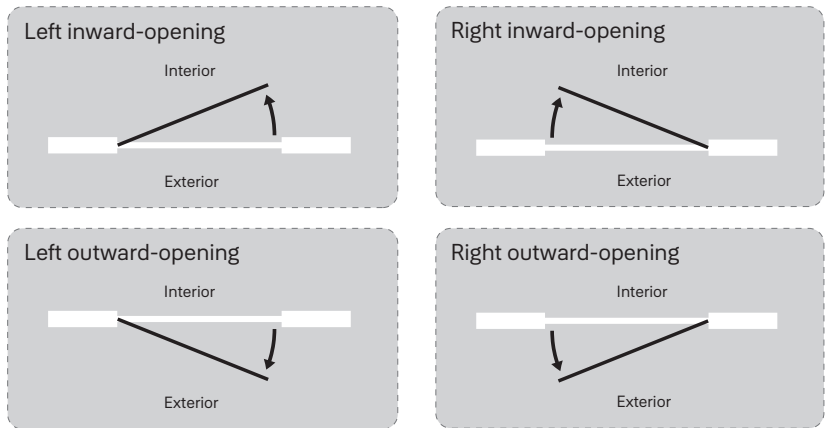

The latch bolt direction is determined by the door opening direction, either left inward-opening, right inward-opening, left outward-opening or right outward-opening

Note

➤ Recommended door gap for installation: 3mm≤door gap≤8mm

1.4 Mortise installation preparation

To determine the latch direction by checking the door opening direction, either left inward-opening, left outward-opening, right inward-opening, right outward-opening, this is to ensure that when the door is closed, the latch bolt can be retracted under the pressure of door frame.

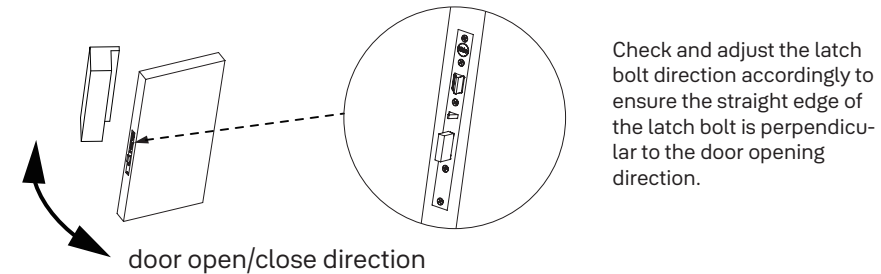

Latch bolt reversing guide as below

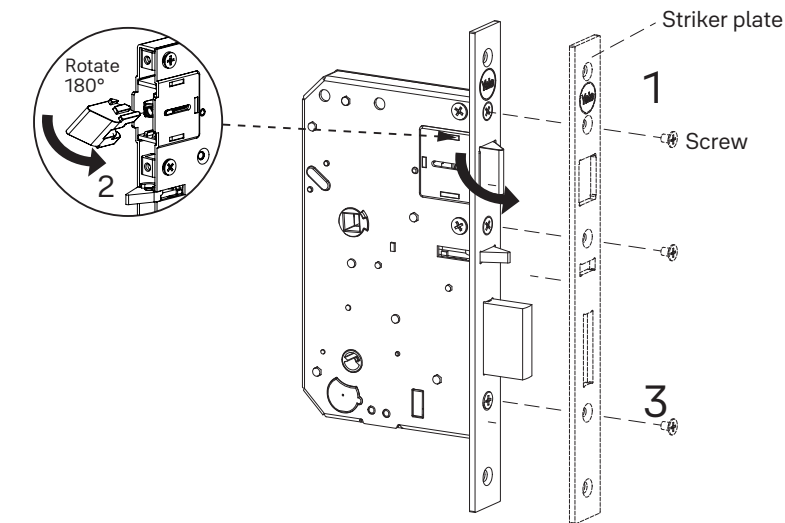

- Step 1. Use a tool to remove screws as show in picture, and disassemble striker plate from mortise.
- Step 2. Remove by pulling out the latch bolt, change the latch bolt direction by rotating 180° manually, and reinsert the latch bolt to the mortise.
- Step 3. After reversing, reinstate the striker plate and screws.



### 1.5 Installation of threaded pull tube, positioning plug and transmission plate

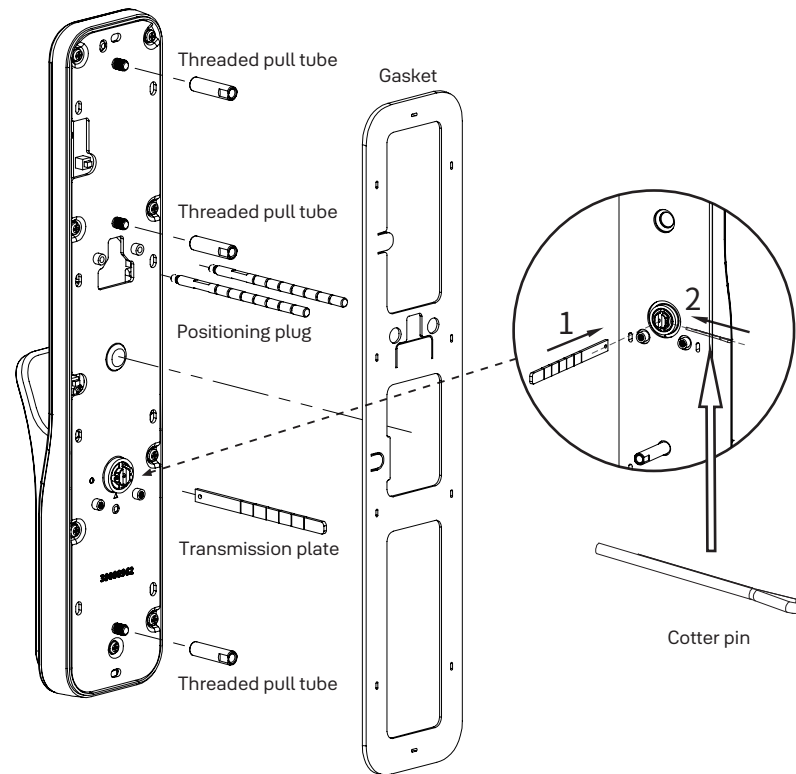

Step 1. Insert transmission plate

Step 2. Bend the cotter pin with a tool to secure the transmission plate.

Step 3. Cut the positioning plug to the required length according to Table 1.2.1 in section 1.2

### 1.6 Main body handle cover removal

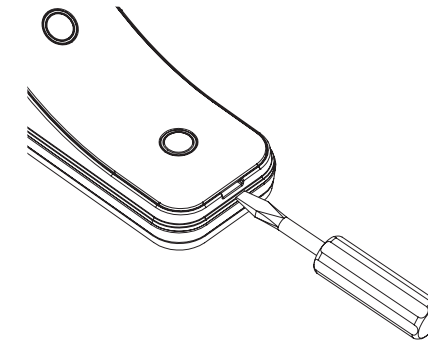

Before installation, use a flat-headed screw driver to detach the handle cover on the main body as shown in the picture above to expose the screw holes for installation later.

### 1.7 Door holes opening

Bore holes on the door using the installation template. Do not close the door during the installation of the product.

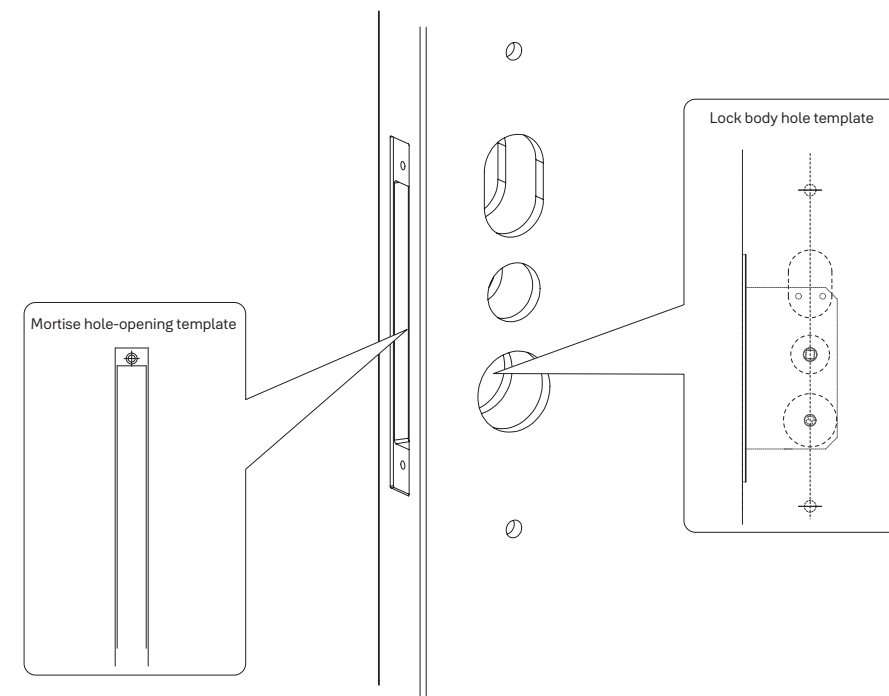



## Product installation

### 2.1 Mortise installation

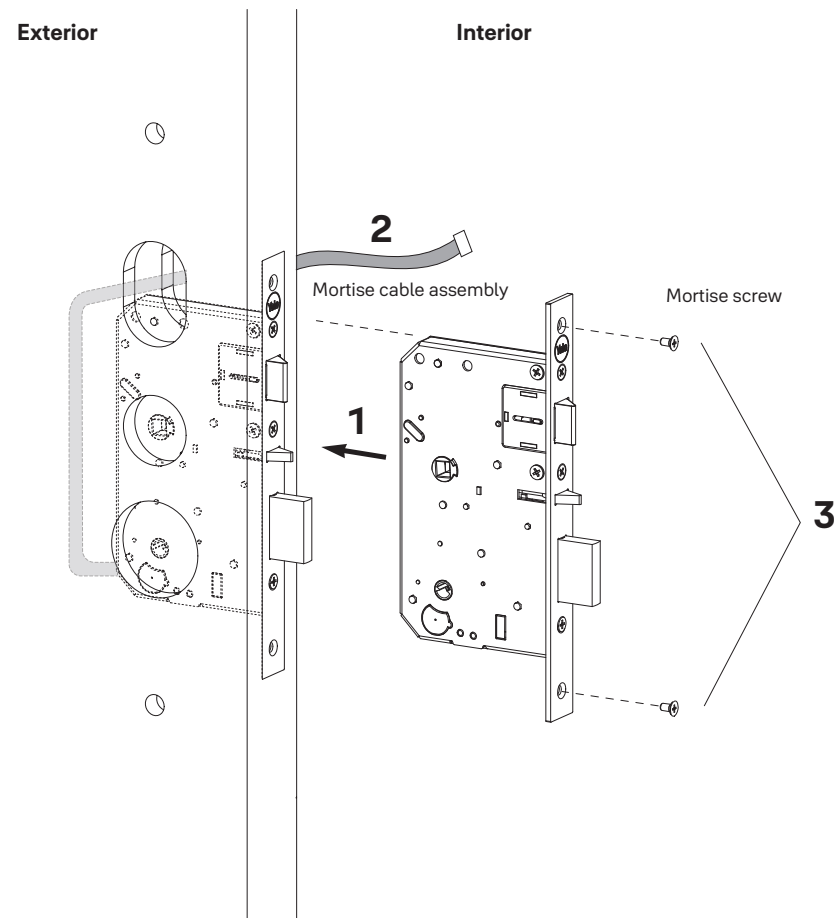

- Step 1. Make hole on the door according to the template provided, insert mortise into door panel.
- Step 2. Ensure the mortise cable is pulled out gently to the interior side of the door through the top hole.
- Step 3. Secure the mortise with the two mortise screws.

### 2.2 Front body installation

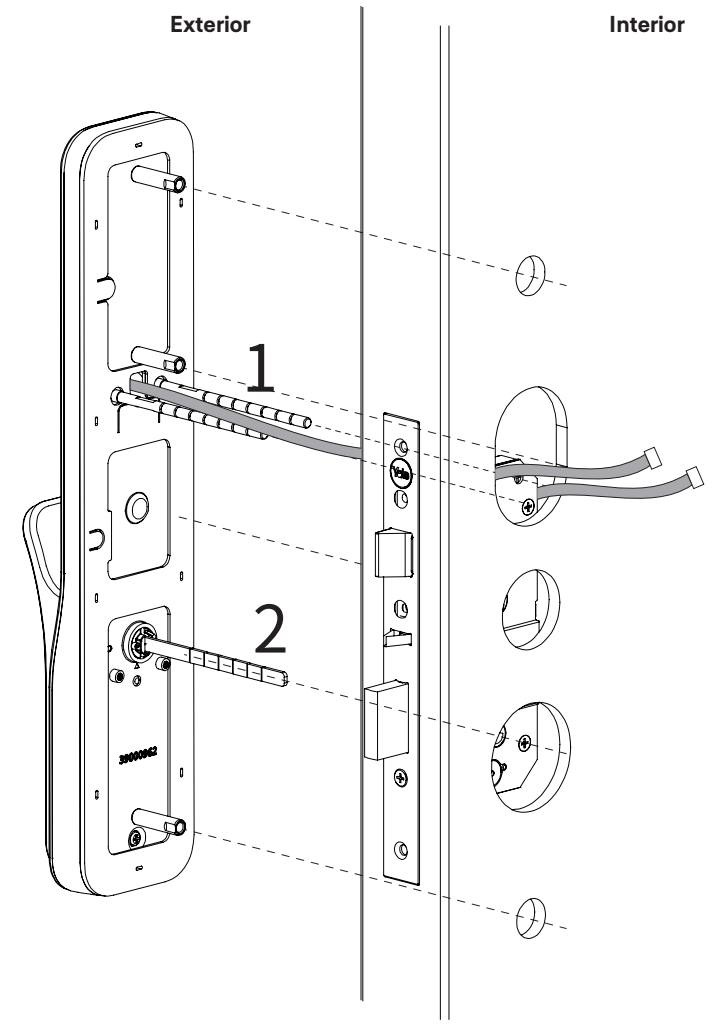

- Step 1. Pull through the front body cable assembly through the top hole as shown in the picture
- Step 2. Align the positioning plug and threaded pull tube to the respective holes, and ensure the front body gasket is tightly secured on the door panel.



## 2.3 Main body plate installation

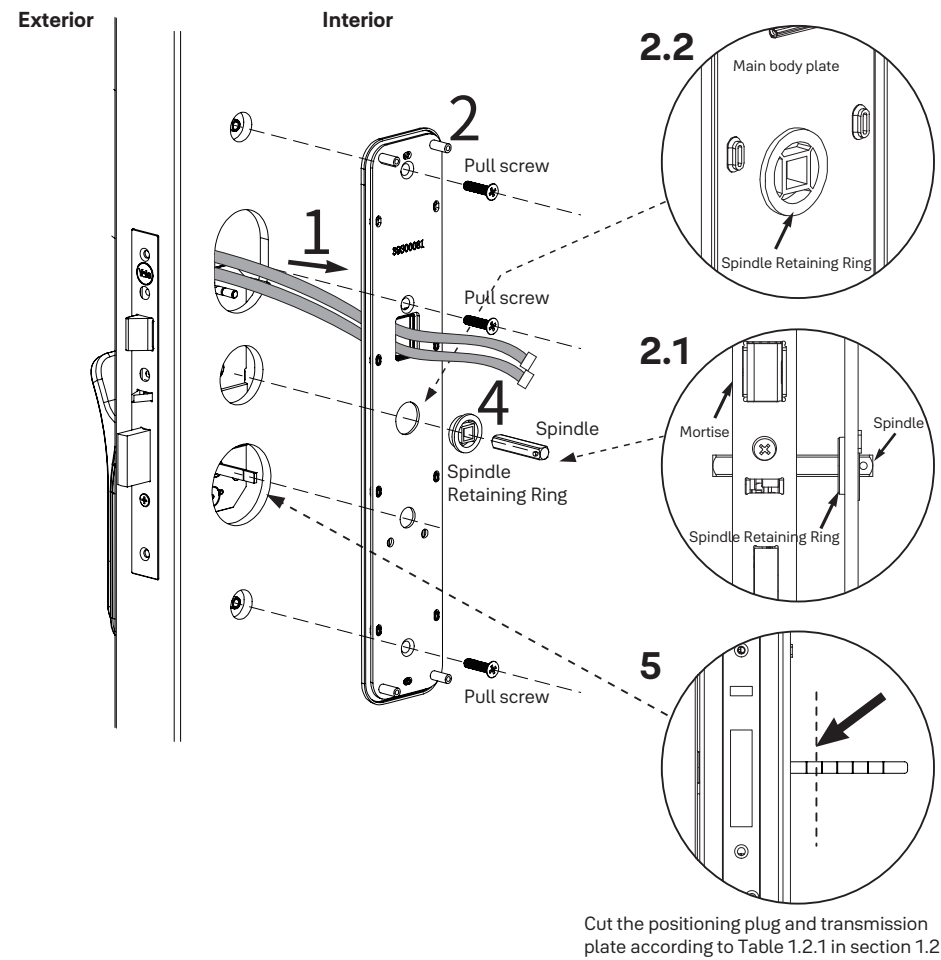

- Step 1. Pull both cable assembly through the main body plate
- Step 2.1. Place the spindle retaining ring to the hole as shown in the picture.
- Step 2.2. Insert the spindle into the mortise through the spindle retaining ring
- Step 3. Secure the main body plate with the pull screws
- Step 4. Remove the spindle retaining ring and the spindle
- Step 5. Cut the transmission plate to the required length according to Table 1.2.1 in section 1.2

## 2.4 Main body installation

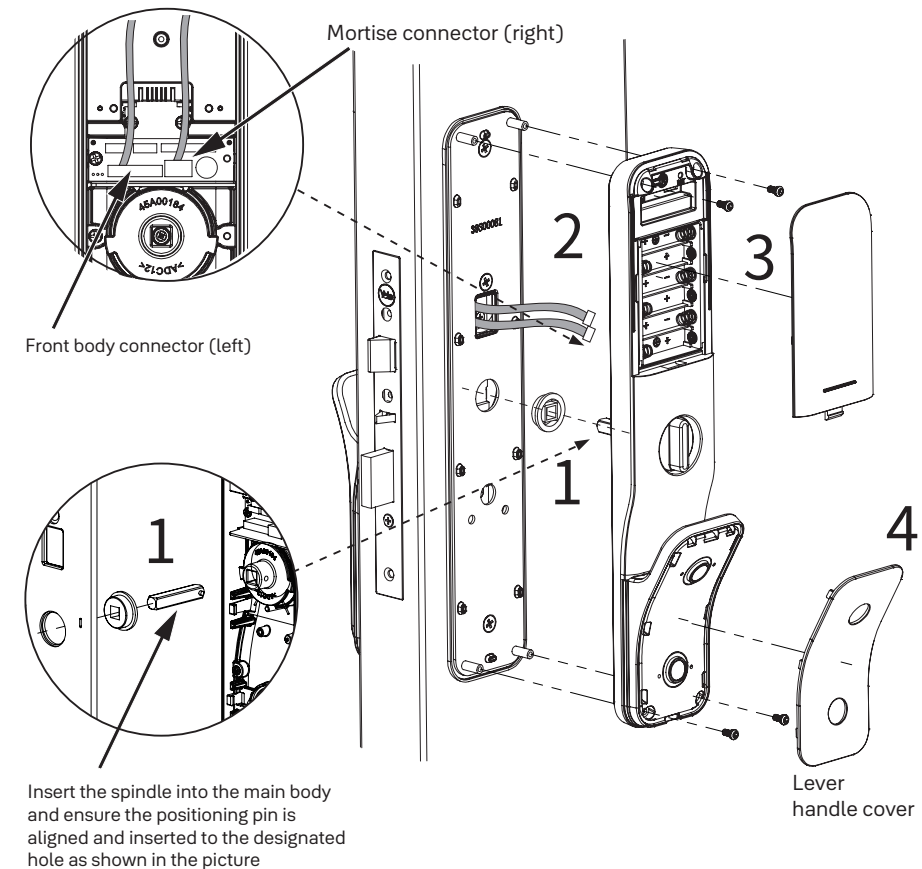

- Step 1. Insert the spindle into the main body. Make sure the positioning pin is aligned and inserted to the designated hole to secure the spindle
- Step 2. Connect the cable assemblies to the respective connectors on the main body. Tuck the excess cables into the door panel
- Step 3. Secure the main body with the round head screws (M4-)
- Step 4. Install the handle cover then the battery



## 2.5 Striker plate and striker box installation

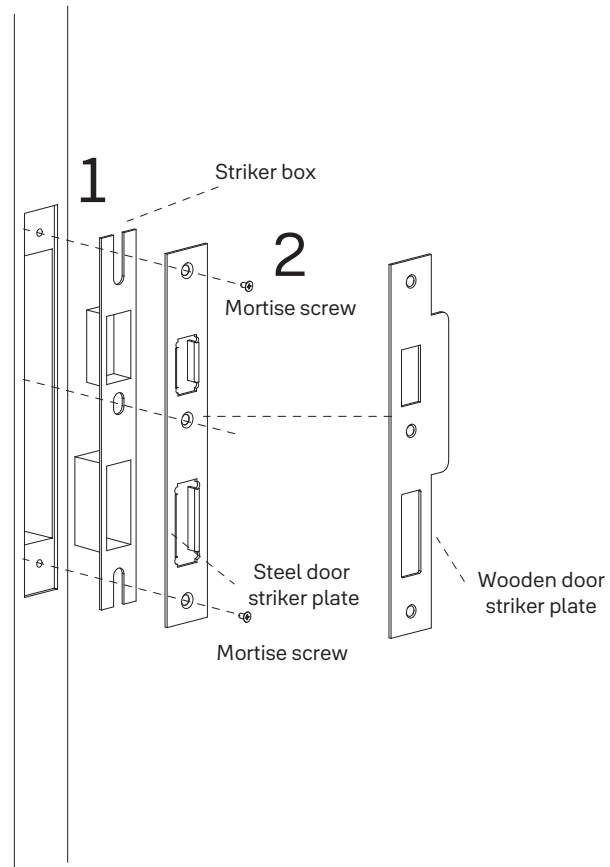

Step 1. Make a hole on the side jamb according to the installation template provided

Step 2. Secure the striker box with the correct striker plate

### Note

- Striker box is needed for wooden door installation only.

## 2.6 Battery installation on main body

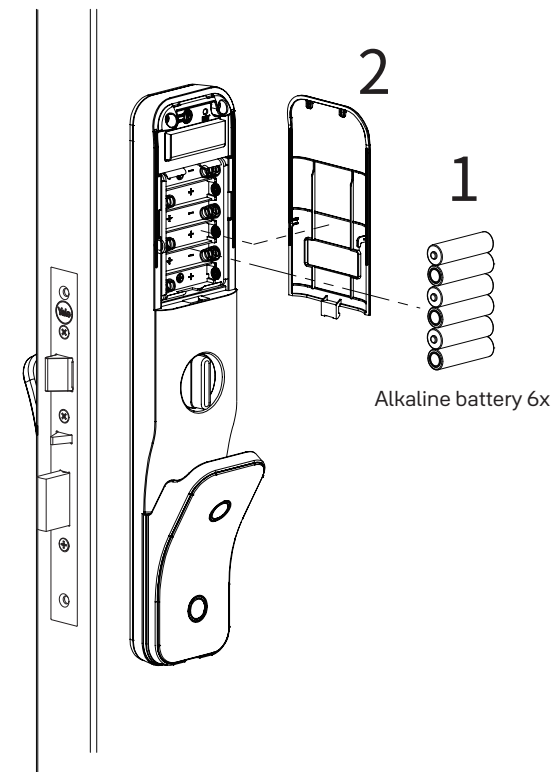

Step 1. Install the battery.

Step 2. Close battery cover

### Note

- To open to battery cover, please press on the bottom-center of the cover (to release the hook) and slide upward.



## 2.7 Acceptance test

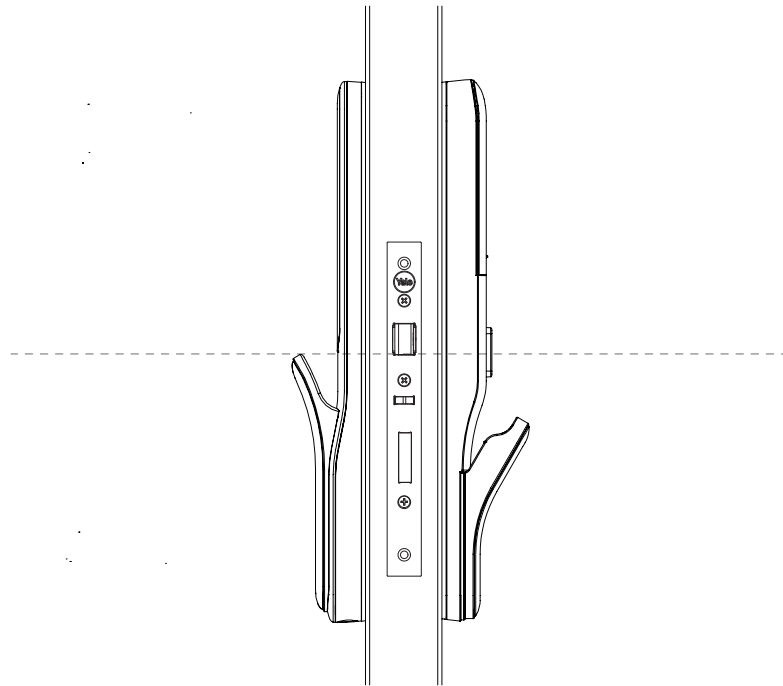

**After the installation of the product is completed, please conduct an acceptance test.**

1. Power on and change the administrator password
2. Front body and main body are parallel with the side jamb
3. Test and verify the connection and the installation of the manual thumb turn, mechanical key override and unlock/lock button
4. Test and verify the functionality of the deadbolt from both the front body and the back body
5. Pull the front body handle hard and ensure no false tampering alarm is triggered
6. Check the door panel condition, ensure no swaying after the deadbolt is protruded into the side jamb
7. Check the functionality of credentials: PIN code, fingerprint scan, card.
8. Check the functionality of other components (networking modules, if any)



**Note**

- Do not conduct the acceptance test with the door closed (except step 6)